

# GO

# GRAND

GRAND HYATT ABU DHABI HOTEL AND  
RESIDENCES EMIRATES PEARL

GRAND | HYATT™



## [ THE HOTEL ]

Grand Hyatt Abu Dhabi Hotel & Residences Emirates Pearl is a luxury hotel and events venue of extraordinary architecture, located in the prestigious West Corniche district of Abu Dhabi, this new 5 star hotel in Abu Dhabi is also conveniently accessible to the city's business hub, high-end shopping districts, and is a short 35-minute drive from Abu Dhabi International Airport and the Louvre Abu Dhabi.

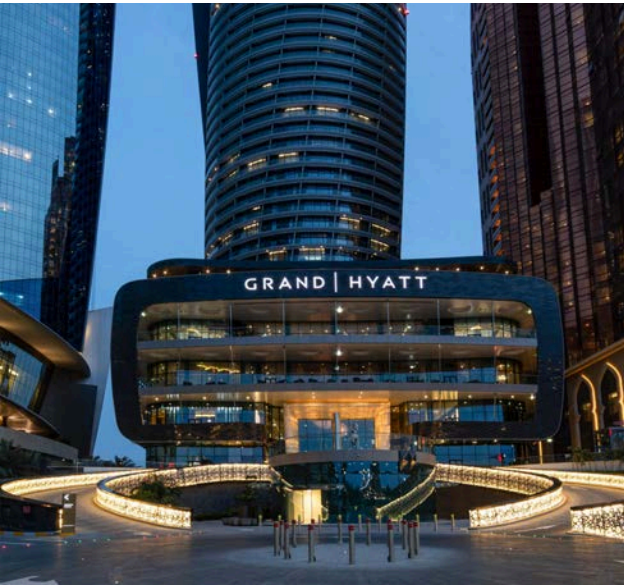

A modern hotel room with a large window overlooking a city and sea. The room features a bed with white linens, a sofa with orange and white pillows, a coffee table, and a framed picture on the wall. The window provides a panoramic view of a city with a large domed building and a body of water.

# ROOMS & SUITES

Grand Hyatt Abu Dhabi Hotel & Residences Emirates Pearl



# THE ROOMS & SUITES

Grand Hyatt Abu Dhabi Hotels and Residences Emirates Pearl is the finest luxury hotel in Abu Dhabi, with 428 rooms, including 332 spacious King and Twin rooms, 36 luxury suites including a Presidential Suite and a Royal Suite, all featuring private balconies, fabulous furnishings with specially-selected room details that provide a taste of the culture of Abu Dhabi and heart-stopping views.

## AMENITIES

- Private Balcony
- Flat-screen HDTV
- Individually controlled heat and air-conditioning
- Hair dryer
- Plush robes and slippers
- Water kettle with tea and coffee making facilities
- Minibar
- In-room safe
- Complimentary mineral water
- Baby bed upon request
- Iron and ironing board
- Connecting rooms available
- Online accessible newspapers and magazines
- Grand Club access available with additional charges



### **King Room / King View Room Grand King Room**

Relax in this 42 sq m guestroom, featuring a plush king bed, floor-to-ceiling windows, and a luxurious bathroom, with views of the Arabian Gulf or the Emirates Palace.



### **Deluxe King Room**

Slip away to this 50 sq m king-bedded guestroom, featuring a private balcony and floor-to-ceiling windows



### **Premier Room**

Slip away to this 72 sq m king-bedded guestroom, featuring a private balcony and floor-to-ceiling windows, lavish amenities including Grand Club access which offers complimentary breakfast, all day tea and coffee and complimentary drinks and appetizers between 6pm and 8pm; with views of the Arabian Gulf or the Emirates Palace.

## Grand Suite

This expansive Grand Suite features 90 sq m of space, stunning views of the Arabian Gulf or the Emirates Palace, a grand living room, a dining area for up to 6 guests, and separate work space. Guests can also enjoy Grand Club access with complimentary breakfast, all day team and coffee and complimentary drinks and appetizers between 6pm and 8pm.



## Pearl Suite

This extravagant Suite features 100 sq m of space, stunning views of the Arabian Gulf or the Emirates Palace, a grand living room, a dining area for up to 6 guests, and separate work space. Guests can also enjoy Grand Club access with complimentary breakfast, all day team and coffee and complimentary drinks and appetizers between 6pm and 8pm.

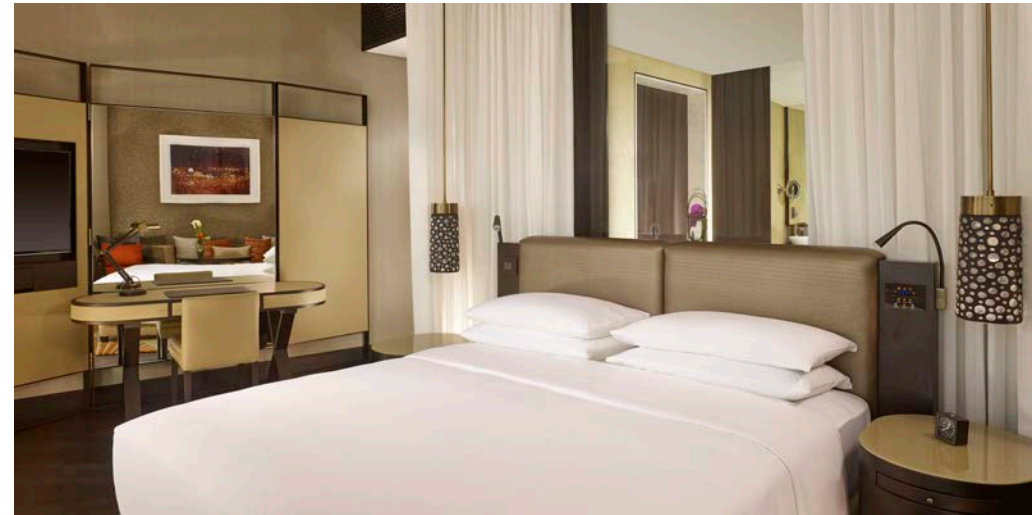



## Presidential Suite

This luxurious suite encompasses 270 sq m of space, with two bedrooms, two bathrooms, a private balcony and views of the Arabian Gulf or Emirates Palace. This suite is uniquely designed to reflect an individual residence in Abu Dhabi and offers separate living room and dining room for up to 10 guests. Guests can also enjoy Grand Club access with complimentary breakfast, all day team and coffee and complimentary drinks and appetizers between 6pm and 8pm.

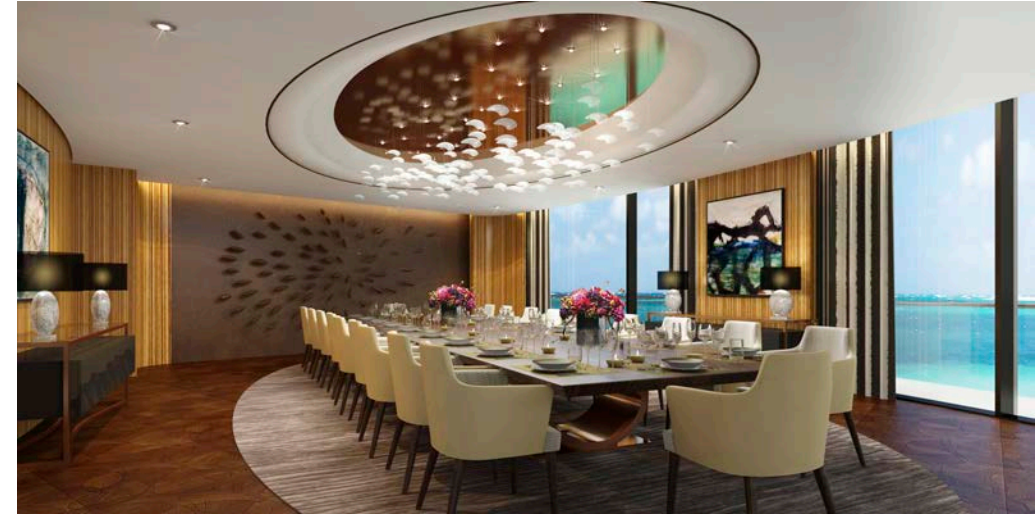

## Royal Suite

This palatial suite encompasses 858 sq m of space, with four bedrooms, each with their own luxurious bathrooms, a private terrace and 360 degrees of views of the Arabian Gulf or Emirates Palace. This suite is uniquely designed to reflect an individual residence in Abu Dhabi and offers separate living room and dining room for up to 20 guests, a family room a separate work area and its own private gym. Guests can also enjoy Grand Club access with complimentary breakfast, all day team and coffee and complimentary drinks and appetizers between 6pm and 8pm.







# RESIDENCES

Grand Hyatt Abu Dhabi Hotel & Residences Emirates Pearl



# RESIDENCES

## One-bedroom Apartment

The one-bedroom residences cover 99 sqm including a Grand King bedroom, a spacious living room, a dining area, a work station and a fully equipped state of the art kitchen, bathrooms and walk-in closets. As well as private balconies.

## Two-bedroom Apartment

The one-bedroom residences cover 99 sqm including a Grand King bedroom, a spacious living room, a dining area, a work station and a fully equipped state of the art kitchen, bathrooms and walk-in closets. As well as private balconies.

## AMENITIES

- Master bedroom
- Spacious and comfortable living room
- Private balconies
- Luxurious bathroom
- Flat-screen HDTV with satellite international channels
- Safety deposit box
- Iron and ironing facilities
- Fully equipped kitchen
- Wine chiller
- Nespresso machine
- Dedicated car parking
- Wi-Fi connectivity
- Electricity, water
- 24-hour security surveillance in all public areas and residence corridors



# VERSO

Grand Hyatt Abu Dhabi Hotel & Residences Emirates Pearl







# VERS0

Verso offers good food that is made to be enjoyed slowly and socially. Slow, because eating the Italian way is about so much more than the meal, it's about sharing moments. And socially, because we are a lot of Italian, we like to talk and laugh and cook and sometimes everything all together, but it's just because we're passionate about what we do, we're passionate about life. Verso, where food means family.



Verso was highly commended in the Best Newcomer category at the Time Out Abu Dhabi Restaurant Awards 2018.





## PEARL LOUNGE

It is a place to meet and talk, eat or wait, think or drink. Or Simply to pause by yourself to relax. Pearl Lounge is what you want it to be.

## SAHHA

Sahha is an adventurous market where every visit serves a new, exciting culinary experience.

## LEXX

A sophisticated bar where legendary moments are made around cellar wines, vintage cigars & classic cocktails complemented by fine Cheese & charcuterie





# AL BATEEN BALLROOM

Grand Hyatt Abu Dhabi Hotel & Residences Emirates Pearl



## CONFERENCES, MEETINGS, EVENTS AND WEDDINGS

With 4700 sq. m. of flexible event space, designed to be the ultimate venue for meetings, special social occasions, weddings, and large scale events in Abu Dhabi,

including Al Bateen Ballroom with a separate entrance, a VIP room and pre-function space. The 12 meetings rooms all enjoy private terraces and natural daylight.





## Capacity Chart



VENUE	VENUE DIMENSIONS H X W X L	VENUE SIZE SQM	BANQUET	COCKTAIL	THEATER	CLASSROOM	CABARET	U-SHAPE	HOLLOW SQUARE
<b>Lower Ground Floor</b>									
<b>AL BATEEN BALLROOM</b>	6.5m x 22.75m x 44m	1040	740	1000	900	594	444	–	–
Section I	6.5m x 22.75m x 27.7m	660	490	650	600	375	360	100	132
Section II	6.5m x 22.75m x 16.3m	380	250	350	300	189	180	75	102
Pre-function Area	5.5m x 14.3m x 38.4m	550	–	550	–	–	–	–	–
VIP Lounge	3m x 7.1m x 17m	125	–	–	–	–	–	–	–
Bridal Room	3m x 5.9m x 11m	65	–	–	–	–	–	–	–
<b>First Floor</b>									
<b>MOUZA</b>	4.2m x 12.5m x 18.6m	235	160	200	216	135	90	57	66
Section I	4.2m x 12.5m x 10.1m	125	90	100	120	80	50	28	40
Section II	4.2m x 12.5m x 8.5m	110	70	90	90	45	42	20	20
<b>HESSA</b>	4.2m x 10.5m x 13m	130	90	110	115	72	48	36	42
Break out reception (MOUZA/HESSA)		350	–	300	–	–	–	–	–
<b>DANA 1</b>	4m x 6.6m x 13.6m	100	50	70	50	36	24	33	33
<b>DANA 2</b>	4m x 5.65m x 11.4m	70	30	50	45	36	18	27	30
<b>DANA 3</b>	4m x 5.65m x 11.4m	70	30	50	45	36	18	27	30
<b>QIMASHA 1</b>	4m x 5.2m x 8.2m	45	20	30	33	20	12	20	24
<b>QIMASHA 2</b>	4m x 5.45m x 8.2m	50	20	30	33	20	12	20	24
<b>QIMASHA 3</b>	4m x 5.4m x 8.2m	50	20	30	33	20	12	20	24
<b>QIMASHA 4</b>	4m x 7.3m x 8.2m	60	20	30	33	22	12	22	26
Pre-function area	–	20	–	–	–	–	–	–	–
<b>BOARDROOM 1 &amp; 2</b>	4m x 4.6m x 5.4m	30	–	–	–	–	–	–	10
Pre-function area	–	20	–	–	–	–	–	–	–



# Floor Plan

## First Floor

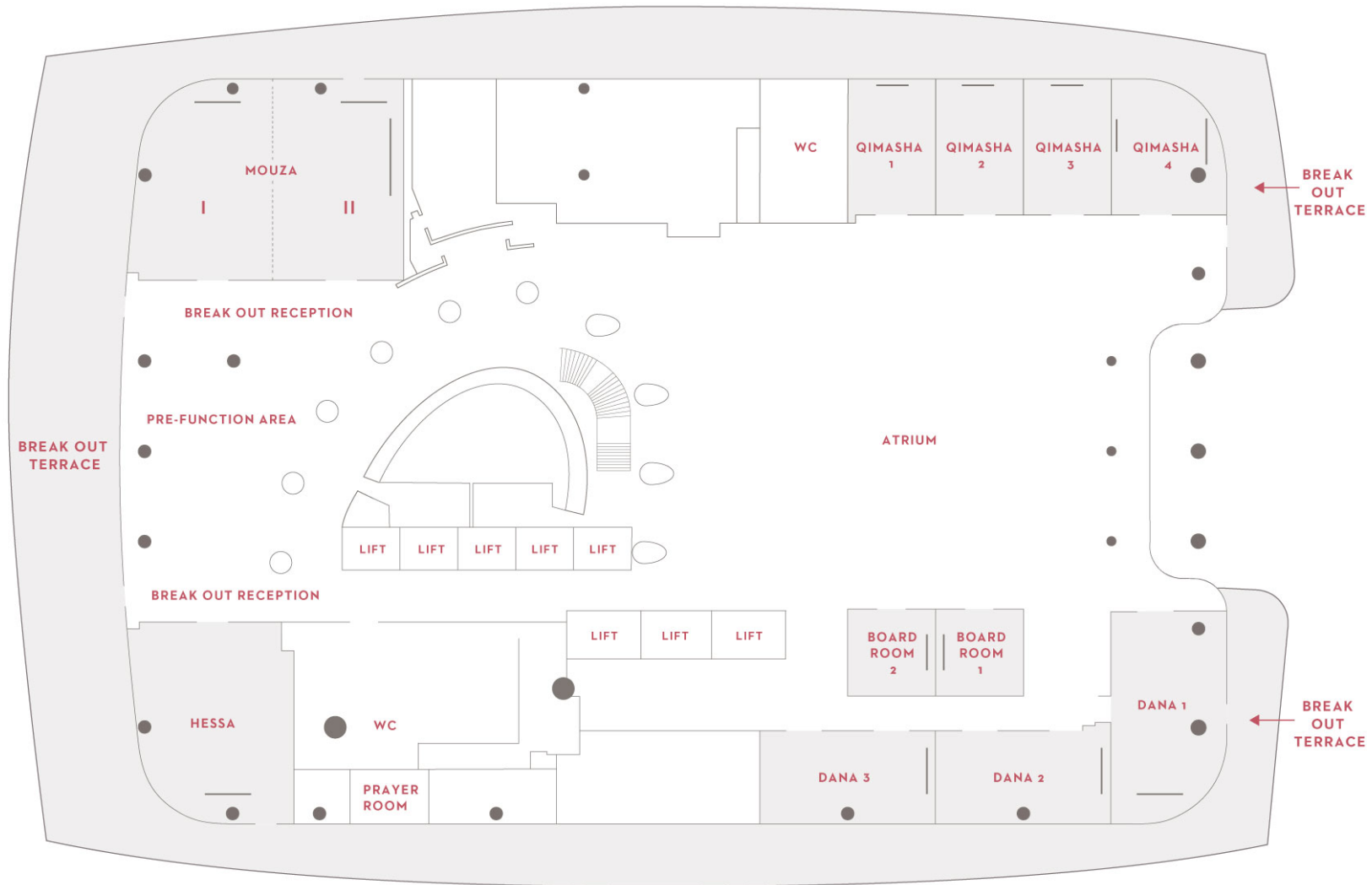



**Floor Plan**  
*Lower Ground Floor*

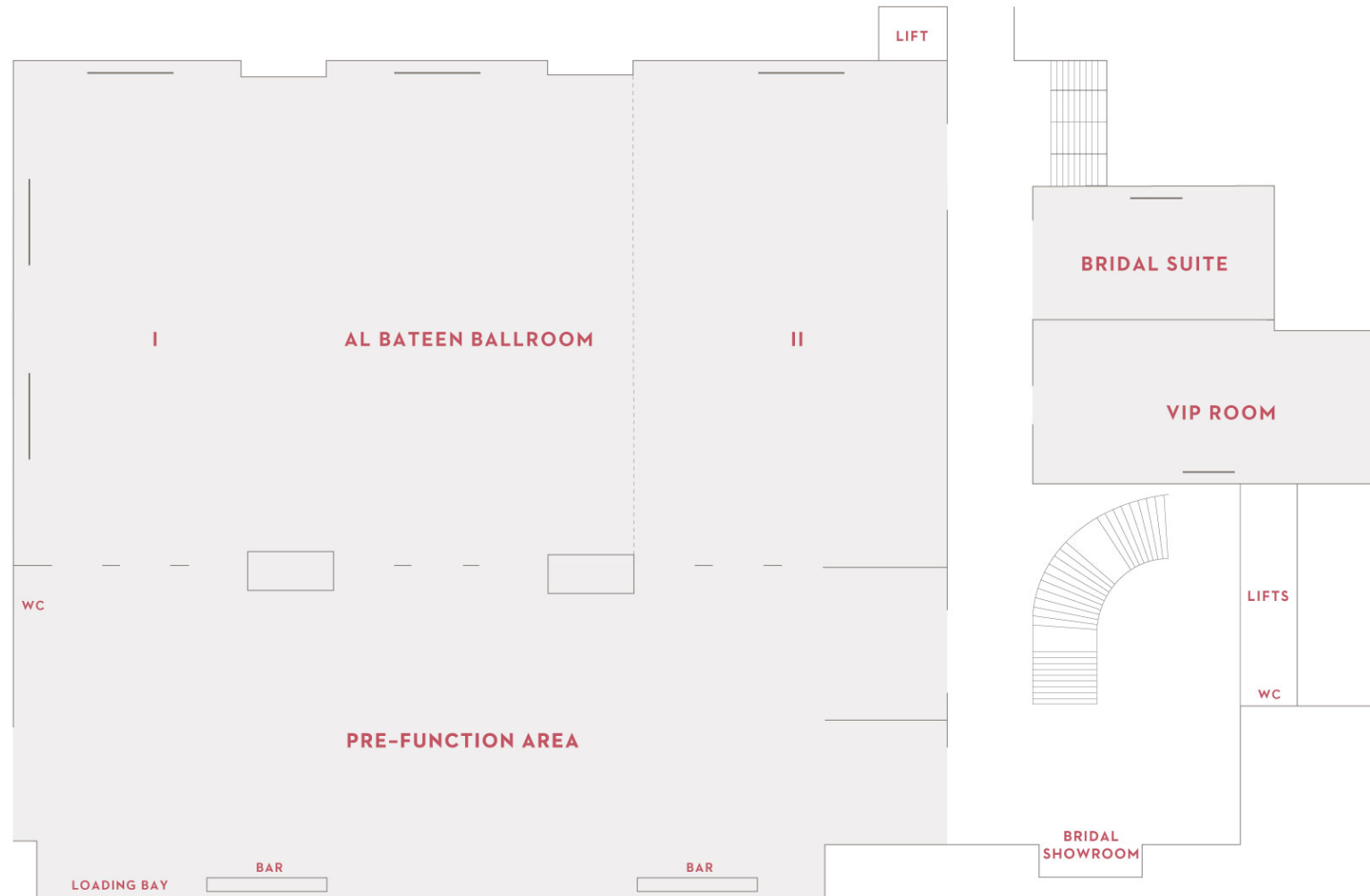



# SWIMMING POOL

Grand Hyatt Abu Dhabi Hotel & Residences Emirates Pearl

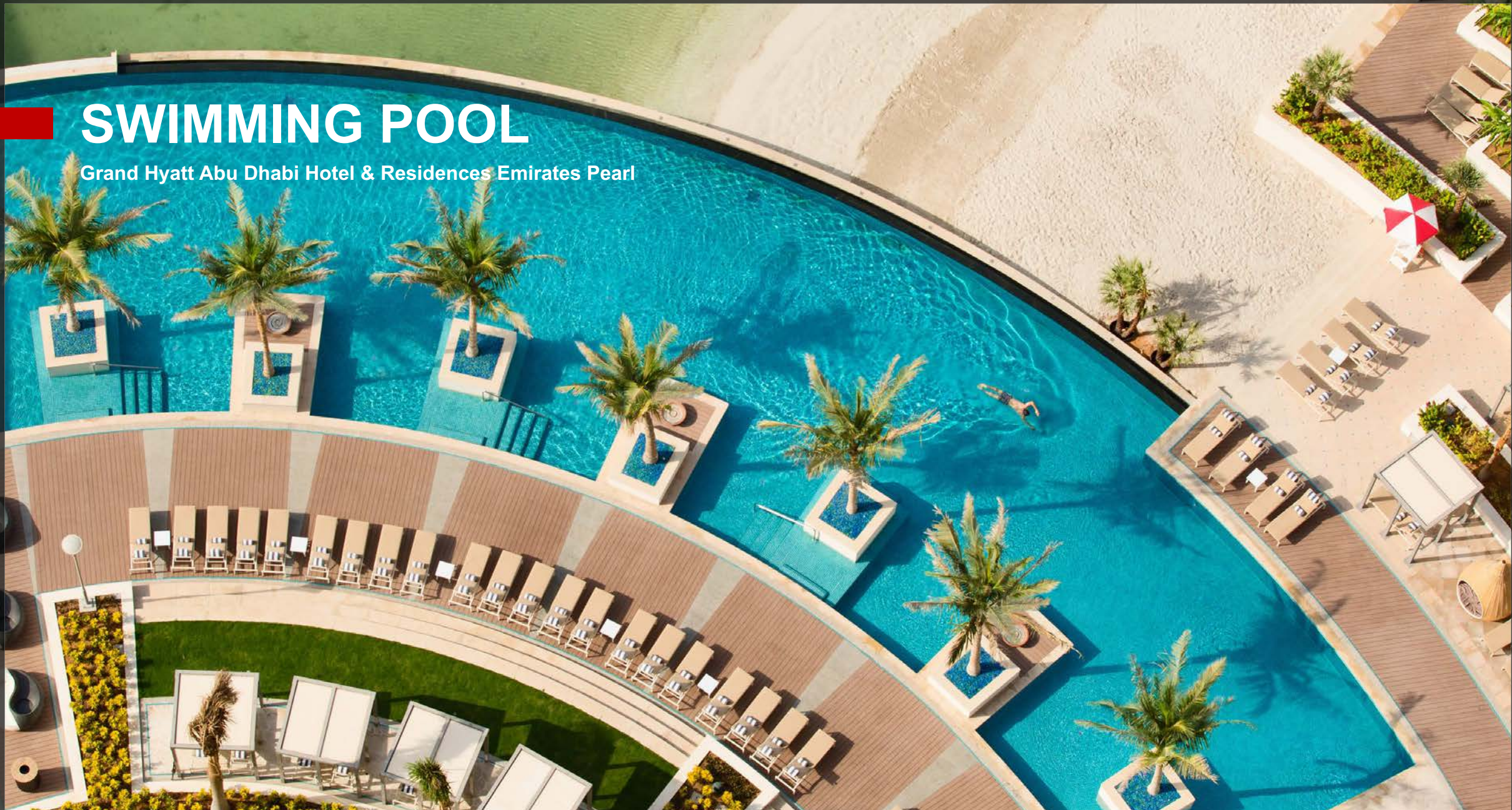





## WELLNESS & RECREATION

A wellness centre extended over an entire floor, offering a Spa with separate male and female areas including Hammam, sauna, steam bath and relaxation rooms, a 50 meters long Infinity Pool, a Kids Pool, a Plunge Pool and a Podium Adult Pool, the wellness centre introduces a modern gym with an outdoor terrace and more.

# LOCATION

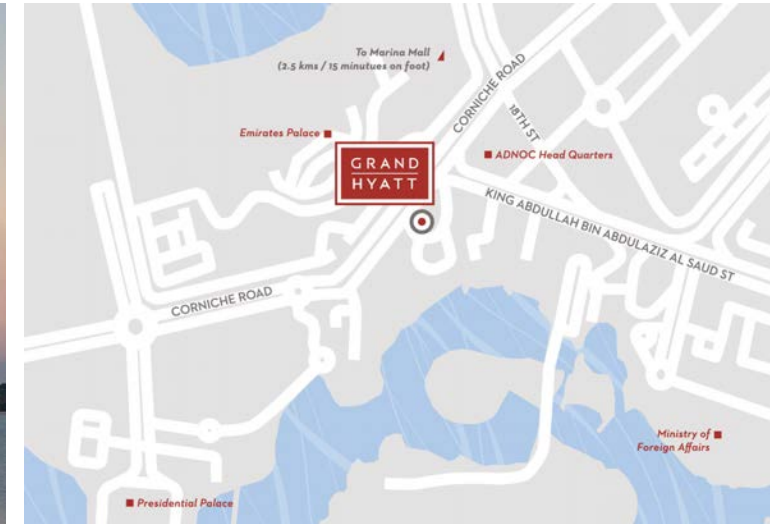

On Prestigious West Corniche District of Abu Dhabi

- Business hub
- High-end shopping districts
- 20 min from Louvre Museum and Sheikh Zayed Mosque
- 35 min from Abu Dhabi International Airport



GO

[ THANK YOU ]

GRAND

GRAND | HYATT™